

Corvan®

SELF-RINSE FLAT MOP

FS36

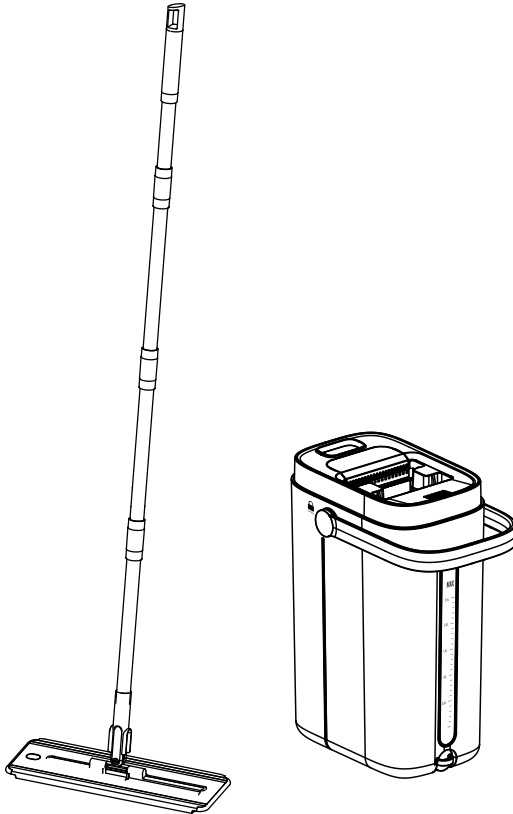

USER MANUAL

Please read this manual carefully before using this product.
We hope you enjoy using this product as much as we enjoyed
developing it and using it daily.

TABLE OF CONTENTS

TABLE OF CONTENTS	_____	2
IMPORTANT SAFETY INSTRUCTIONS	_____	2
PRODUCT PARTS	_____	3
PREPARING TO USE	_____	3-4
USING	_____	4-6
CLEANING AND MAINTENANCE	_____	6
TECHNICAL SPECIFICATIONS	_____	6
TROUBLESHOOTING	_____	7
WARRANTY POLICY	_____	7

IMPORTANT SAFETY INSTRUCTIONS

1. Read all instructions before using the flat mop.
2. For indoor, domestic use only.
3. Do not use the flat mop if any part is damaged, bent, or broken. Contact Corvan for service or replacement.
4. Children under 8 years old should not use this product.
5. The mop is not a toy. Use with care around children and pets.
6. Do not attempt to modify, tamper with, or repair the product yourself.
7. Use caution on slippery or uneven floors to avoid slips or falls.
8. Store the mop in a dry, well-ventilated place when not in use.
9. Do not leave the mop immersed in water for extended periods to avoid damage.
10. Use only genuine Corvan mop pads and parts for best performance.
11. Regularly inspect the mop handle and head for signs of wear or looseness.

PRODUCT PARTS

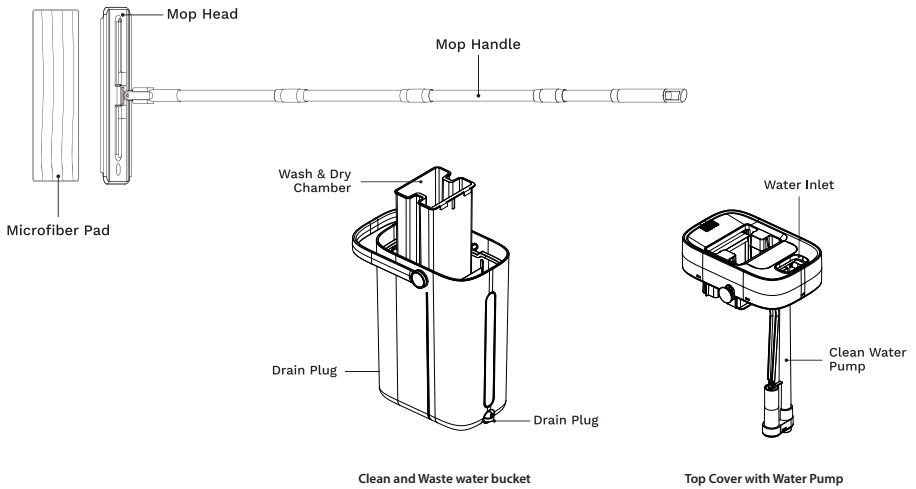

What's in the package

Mop Handle (4-piece pole)	x 1	Top Cover with Water Pump	x 1
Mop Head	x 1	Drain Plug	x 2
Microfiber Mop Pad	x 1	Clean and Waste water bucket	x 1
Wash and Dry Chamber	x 1		

PREPARING TO USE

Assemble the Mop Handle

Connect Mop Handle 1, 2,3 and 4 together in sequence, insert into the Mop Head and secure it tightly (Fig 1).

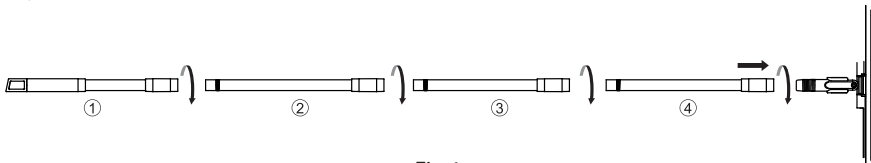

Fig 1

PREPARING TO USE

Attach the Microfiber Mop Pad

1. Align and insert the tabs on the mop head with the corresponding slots on the Microfiber Mop Pad (Fig 2).
2. Press the pad firmly onto the mop head so it lays flat and sticks smoothly (Fig 3).
3. To open the latch, press the release button on the side of the mop head (Fig 4).
4. Slide the three latch tabs into the matching slots on the Microfiber Mop Pad, then press the latch down until it locks securely (Fig 5).

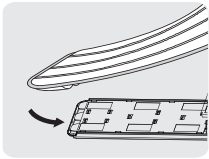

Fig 2

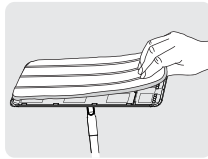

Fig 3

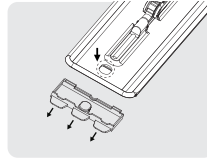

Fig 4

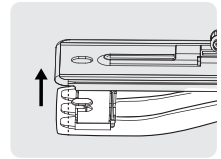

Fig 5

USING

Unlock and Lock the Top Cover with Water Pump

1. Unlock the Top Cover with Water Pump by rotate the handle to Open Logo (Fig 6).
2. Lock the Top Cover with Water Pump by rotate the handle to Lock Logo (Fig 7).

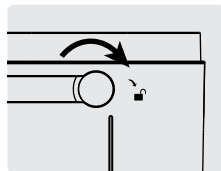

Fig 6

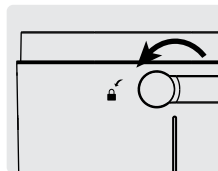

Fig 7

Fill with Clean Water

1. Make sure the Top Cover and Water Pump is well placed in the Clean and Waste water bucket
2. Fill the clean water, keeping it below the Max Water Level (Fig 8).

CAUTIONS: DO NOT exceed 60°C (140°F)

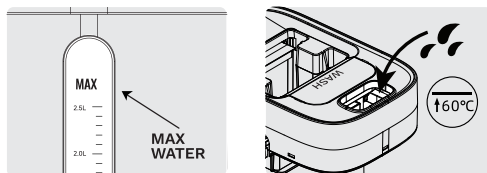

Fig 8

Washing and Drying the Mop

1. Insert the folded mop head vertically into the WASH chamber (✓) (Fig 9). Avoid inserting it at an angle (X) (Fig 10). Move the handle up and down to rinse the mop thoroughly (Fig 11).
2. Shift to the DRY chamber and repeat the motion to remove excess water (Fig 12).

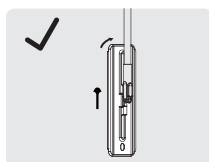

Fig 9

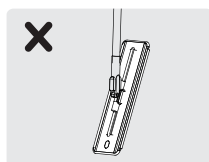

Fig 10

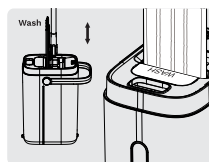

Fig 11

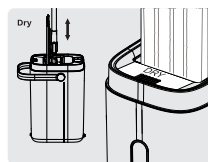

Fig 12

Wiper function

1. Flip the mop head to expose the wiper strip, keeping it facing away from you (Fig 13).
2. Gently push or pull the mop to scrape off excess water or residue (Fig 14).

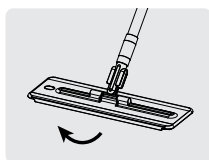

Fig 13



Fig 14

USING

Emptying the dirty and clean water

1. Pull out the drain plug to release and pour out the water (Fig 15).
2. After draining, securely reattach the plug before the next use.

WARNING: Ensure the plug is tightly closed to prevent any water leakage.

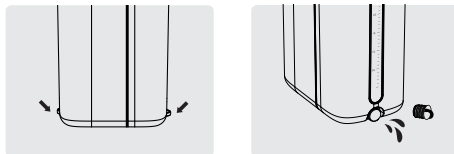

Fig 15

CLEANING & MAINTENANCE

1. Rinse the microfiber mop pad thoroughly after each use to prevent odor and residue build up.
2. Clean the bucket interior regularly with fresh water to maintain hygiene.
3. Ensure the pump area is clear of debris before each use to maintain proper water flow and performance.

TECHNICAL SPECIFICATIONS

Model	:	FS36
Clean water tank capacity	:	3.5l(max.)
Waste water tank capacity	:	3.5l(max.)
Dry chamber capacity	:	2.5l
Bucket dimension	:	26(W)x17(D)x39.5(H)cm
Mop head dimension(with mop pad)	:	36(W)x11.2(D)x 2(H)cm
Net weight (mop with extension rod)	:	0.6kg
Net weight (bucket+mop)	:	2.33kgs
Mopping pole length	:	135cm(max)
Minimum clearance	:	4.8cm

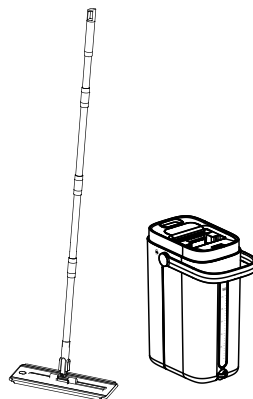

TROUBLESHOOTING

	Issue	Suggested Solutions
1	<ul style="list-style-type: none">• Water cannot come out	<ul style="list-style-type: none">• Check the pump mechanism is working or not
2	<ul style="list-style-type: none">• Microfiber Mop Pad detaches during use	<ul style="list-style-type: none">• Ensure it clicks firmly into place and tabs are aligned

WARRANTY POLICY

Corvan Asia Sdn Bhd (Corvan) warrants to the original purchaser ("you" or "your") that your Corvan Manual Flat Mop (the "Product") is free from defects in material and workmanship under normal household use for a period of 1 year from the date of original purchase.

Remedies

To the maximum extent permitted by applicable law, Corvan's sole liability and your exclusive remedy for any breach of warranty during the applicable warranty period shall be, at Corvan's option, to repair or replace the Product. Any replacement Product will be warranted for the remainder of the original warranty period.

How to Obtain Warranty Support

Please contact Corvan's technical support at 603-77288166 or email crm@corvan.com.my for assistance.

Exclusions

This warranty does not cover consumable parts such as mop pads, or damage caused by misuse, accident, commercial use, improper maintenance, or unauthorized modification. The warranty is void if the product is used outside of Malaysia, or purchased from an unauthorized dealer.

Limitation of Liability

TO THE MAXIMUM EXTENT PERMITTED BY APPLICABLE LAW, CORVAN SHALL NOT BE LIABLE FOR LOSS, WHETHER DIRECT OR INDIRECT, OF REVENUE OR PROFITS, FAILURE TO REALIZE SAVINGS OR OTHER BENEFITS OR ANY OTHER SPECIAL, INCIDENTAL OR CONSEQUENTIAL DAMAGES CAUSED BY THE USE OR INABILITY TO USE THIS PRODUCT. CORVAN'S ENTIRE LIABILITY SHALL BE LIMITED, AT CORVAN'S OPTION, TO REPLACEMENT OR REPAIR OF THE PRODUCT OR REFUND OF THE PURCHASE PRICE PAID.

No Other Warranties

No Corvan dealer, agent, or employee is authorized to make any modification, extension, or addition to this warranty.

Governing Law

This Limited Warranty shall be governed by the laws of Malaysia.

May 13, 2025

Thank You For Purchasing A Corvan Product.

Please scan the QR code to visit www.corvan.com.my/support for technical support.



[corvan.com.my/support](http://www.corvan.com.my/support)

Corvan[®]

Service Centre

T01 & T02, 3rd Floor, Atria Shopping Gallery,

Jalan SS22/23, Damansara Jaya, 47400

Petaling Jaya, Selangor, Malaysia

Tel: 603-7728 8166

Email: crm@corvan.com.my

Website: www.corvan.com.my

Corvan is a registered trademark of Corvan Asia Sdn Bhd.

COPYRIGHT 2025 ALL RIGHTS RESERVED